

# USER'S MANUAL

## H.265/MJPEG 2Mega STARVIS IP Stainless Steel IR Bullet Camera



**CAUTION**

RISK OF ELECTRIC SHOCK  
DO NOT OPEN

CAUTION : TO REDUCE THE RISK OF ELECTRIC SHOCK,  
DO NOT REMOVE COVER  
NOT USER SERVICEABLE PARTS INSIDE  
REFER SERVICING TO QUALIFIED SERVICE PERSONNEL

### Dimensions

**Part name & Dimension**

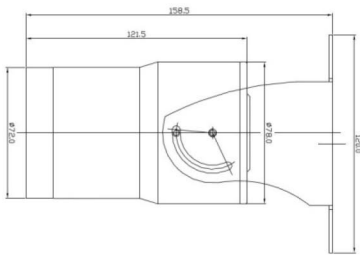

### Accessories



Screws Mounting screws CD



Wall mount bracket (option)

### Installation

**Step.1**

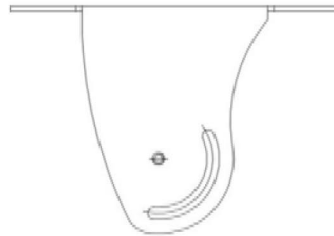

Fixing bracket at desired place

**Step.2**

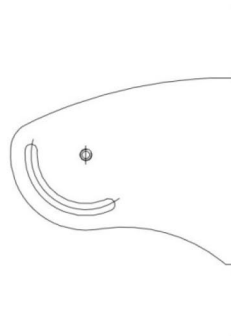

Adjust view angle with 3-axis bracket

### Cable

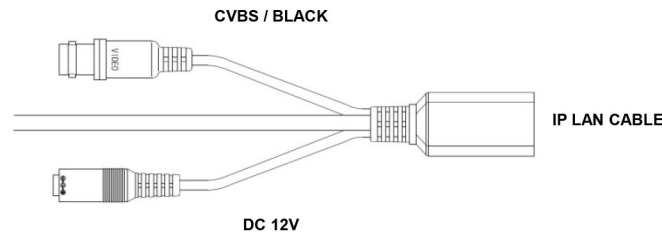

### Features

- 1/2.8" Sony 2Mega STARVIS image sensor
- Max. 30fps/Full HD (1920x1080) Resolution
- ONVIF profile S Compliant
- Triple codec(H.264, H.265, MJPEG)
- 3.6mm megapixel fixed lens
- True Day & Night with ICR mechanism
- Real-WDR(Wide Dynamic Range)
- 3D DNR (Digital Noise Reduction)
- Option: PoE (IEEE802.3af)

### Specifications

Model	EC-NPP-Stronghold-MPIRIP
Image Sensor	Sony 2Mega STARVIS image sensor
Size	1/2.8 inch
Scan System	Progressive Scan
Total Pixels	2000(H) x 1121(V), 2.24 Mega Pixels
Effective Pixels	1984(H) x 1105(V), 2.19 Mega Pixels
Day & Night	Auto / Day(Color) / Night(BW), ICR Control
Privacy Area	On / Off (6 Programmable Zones)
Motion Detection	48 Zone, Sensitivity 1 ~ 5 Step, On / Off
L P R	Auto, 1/15 ~ 1/9000, On / Off
Real W D R	WDR, On/Off
3 D N R	Digital Noise Reduction, 1 ~ 63 Step
Elec. Shutter	Auto(1/15~1/15000), Suppress Rolling, Manual
Color adjust	Bright / Contrast / Saturation / Sharp / Hue
White Balance	Auto / Indoor / Outdoor / Fluorescent
OSD Display	Text, Data, Time, Event, On / Off
Image Mirror	Normal / Mirror(H) / flip(V) / Both(HV)
Ext, Video	VBS 1.0Vp-p
Power Supply	DC12[V] ± 10%
Operating Temp	0 °C ~ +50 °C
Preservation Temp	-10 °C ~ +60 °C
Humidity	0% ~ 90%
Lens	3.6mm megapixel fixed lens
Dimension/mm	Φ76 X 158.5(W) X 120(H)
Weight/g	Approx. 1520

All specification and pictures are subject to change without notice to improve quality.